



FISHER MANUFACTURING COMPANY TOLL FREE: 800-421-6162 - FAX: 800-832-8238
customer@fisherfaucets.com - www.fisherfaucets.com

PRODUCT NAME:

PRERINSE SPG 8AWCDLH INTL

SPEC. PICB-SP-8AWLL

Customer/Wholesaler:	Date:	Job Name:	Model Specified:	Quantity:
Contractor:		Architect/Engineer:		

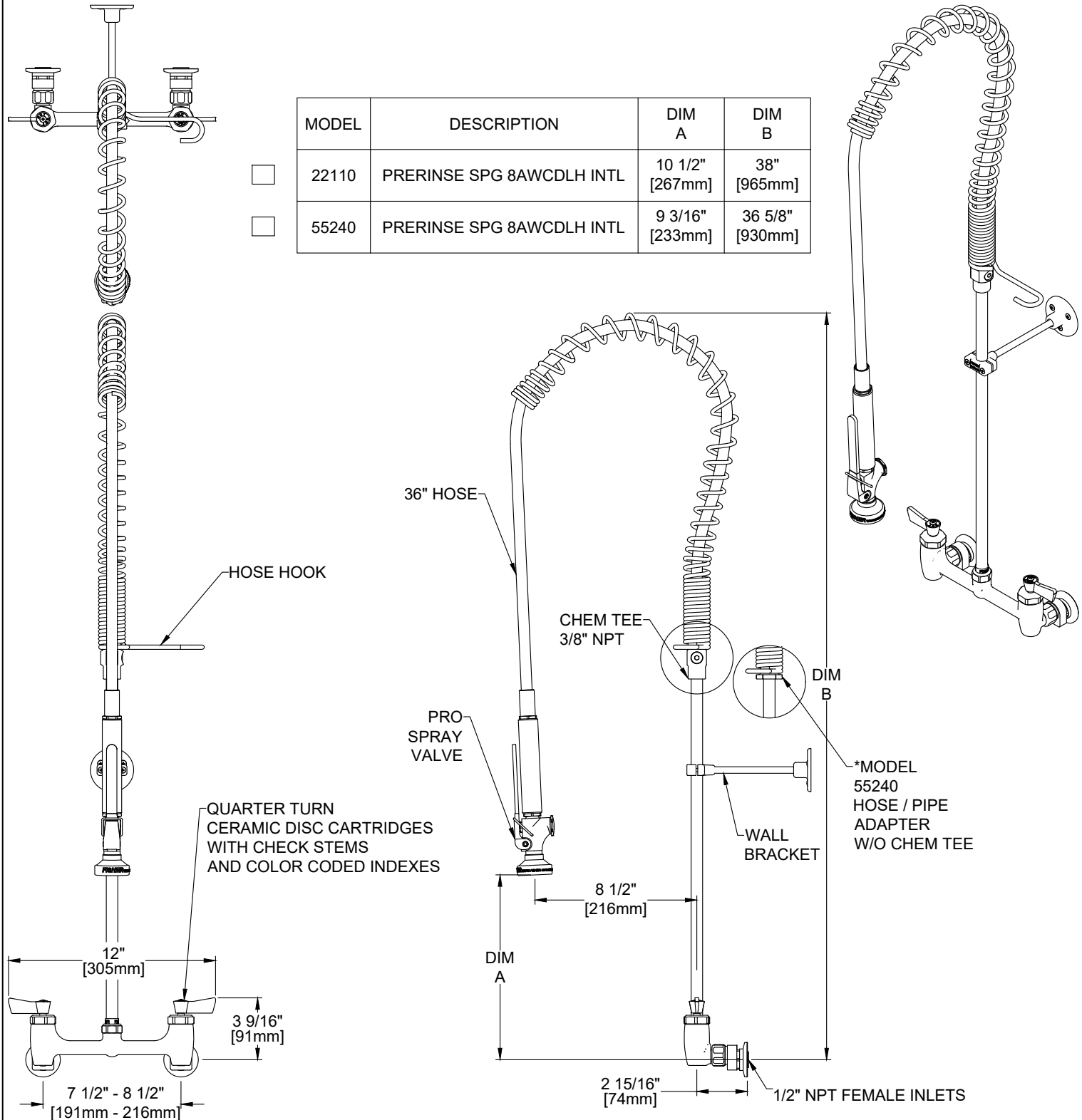

MODEL	DESCRIPTION	DIM A	DIM B
<input type="checkbox"/> 22110	PRERINSE SPG 8AWCDLH INTL	10 1/2" [267mm]	38" [965mm]
<input type="checkbox"/> 55240	PRERINSE SPG 8AWCDLH INTL	9 3/16" [233mm]	36 5/8" [930mm]

PRODUCT SPECIFICATIONS: PRE-RINSE UNIT: 8" ADJUSTABLE WALL MOUNT MIXING FAUCET, QUARTER TURN CERAMIC DISC CARTRIDGES W/CHECK STEMS, LEVER HANDLES, 36" FLEXIBLE STAINLESS STEEL HOSE, 2.65 GPM @ 80 PSI SPRAY VALVE, 12" WALL BRACKET, 1/2" NPT FEMALE INLETS		PRODUCT COMPLIANCE: ASME A112.18.1 / CSA B125.1 NSF 61 - Section 9 NSF 372 (Low Lead Content)	
Drawn: LC	Checked: EM	Approved: LC	Date: 03/06/24
Sheet:			1 of 2

Customer/Wholesaler:	Date:	Job Name:	Model Specified:	Quantity:
Contractor:		Architect/Engineer:		

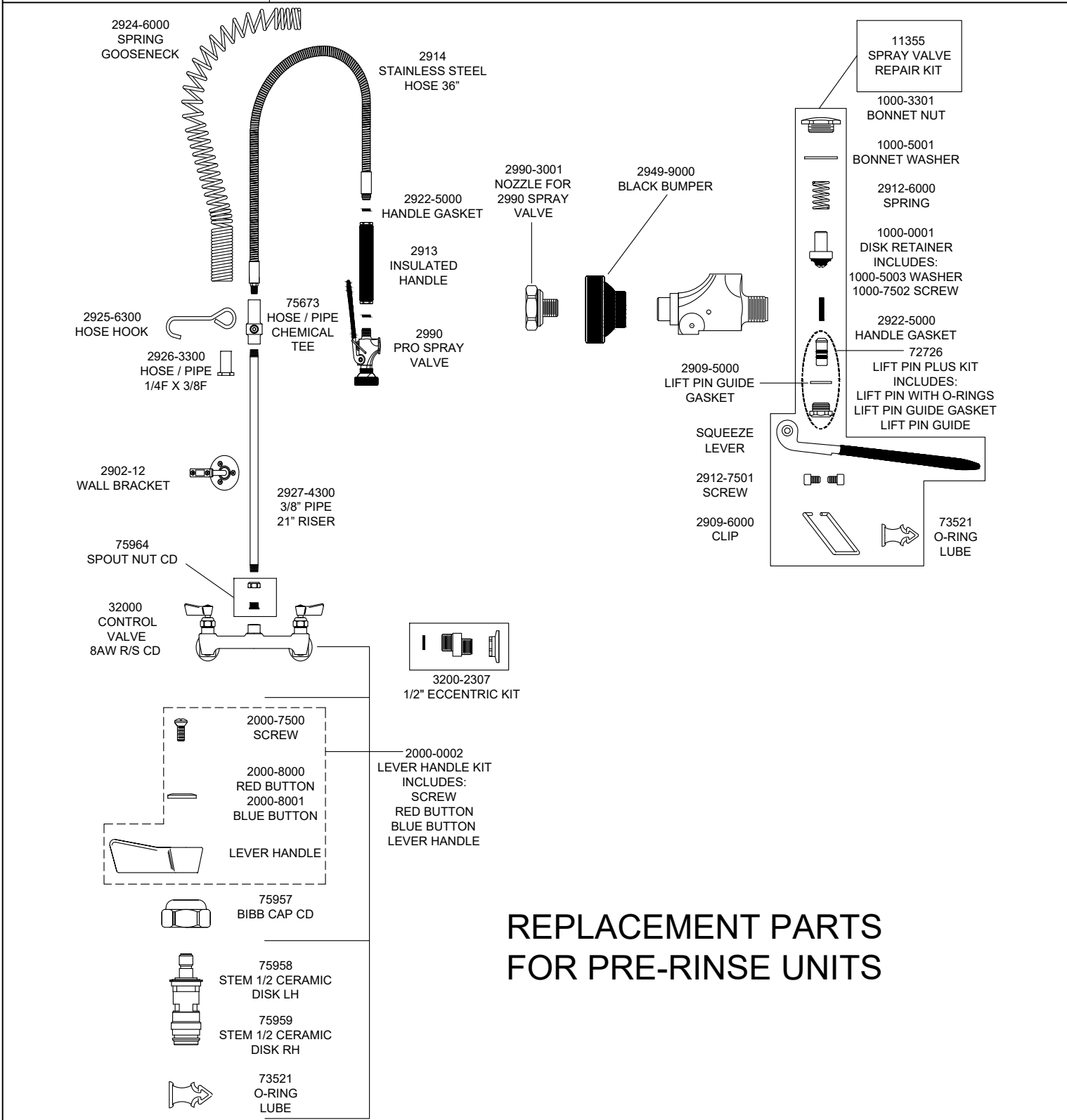

REPLACEMENT PARTS FOR PRE-RINSE UNITS

PRODUCT SPECIFICATIONS: PRE-RINSE UNIT: 8" ADJUSTABLE WALL MOUNT MIXING FAUCET, QUARTER TURN CERAMIC DISC CARTRIDGES W/CHECK STEMS, LEVER HANDLES, 36" FLEXIBLE STAINLESS STEEL HOSE, 2.65 GPM @ 80 PSI SPRAY VALVE, 12" WALL BRACKET, 1/2" NPT FEMALE INLETS		PRODUCT COMPLIANCE: ASME A112.18.1 / CSA B125.1 NSF 61 - Section 9 NSF 372 (Low Lead Content)	
Drawn: LC	Checked: EM	Approved: LC	Date: 03/06/24
Sheet:		2 of 2	